



# DOWNING COLLEGE STUDENT PLAN

dow|2017c

0m 25m 50m  
approximate

- 1 B Staircase Offices  
Bursary  
Catering Managers  
College Accountant  
Internal Events Booking  
I.T. Office  
Tutorial and Admissions

- 3 Assistant Bursar,  
Information &  
Communications

- 7 Chapel

- 4 College Office

- 13 Computer Room

- 5 Conference Services  
Office

- 6 Development and  
Alumni Office

- 2 Human Resources

- 14 Laundries

- Level entrances to  
West Range staircases

- 8 Lord Butterfield  
Bar & Café

- 9 Maitland Robinson Library

- 12 MCR / Common Room

- 11 Nurse (O Staircase, Room 5)

- 3 Operations Manager

- 10 Porters' Lodge  
Accommodation Officer  
Domus Manager  
Head Porter

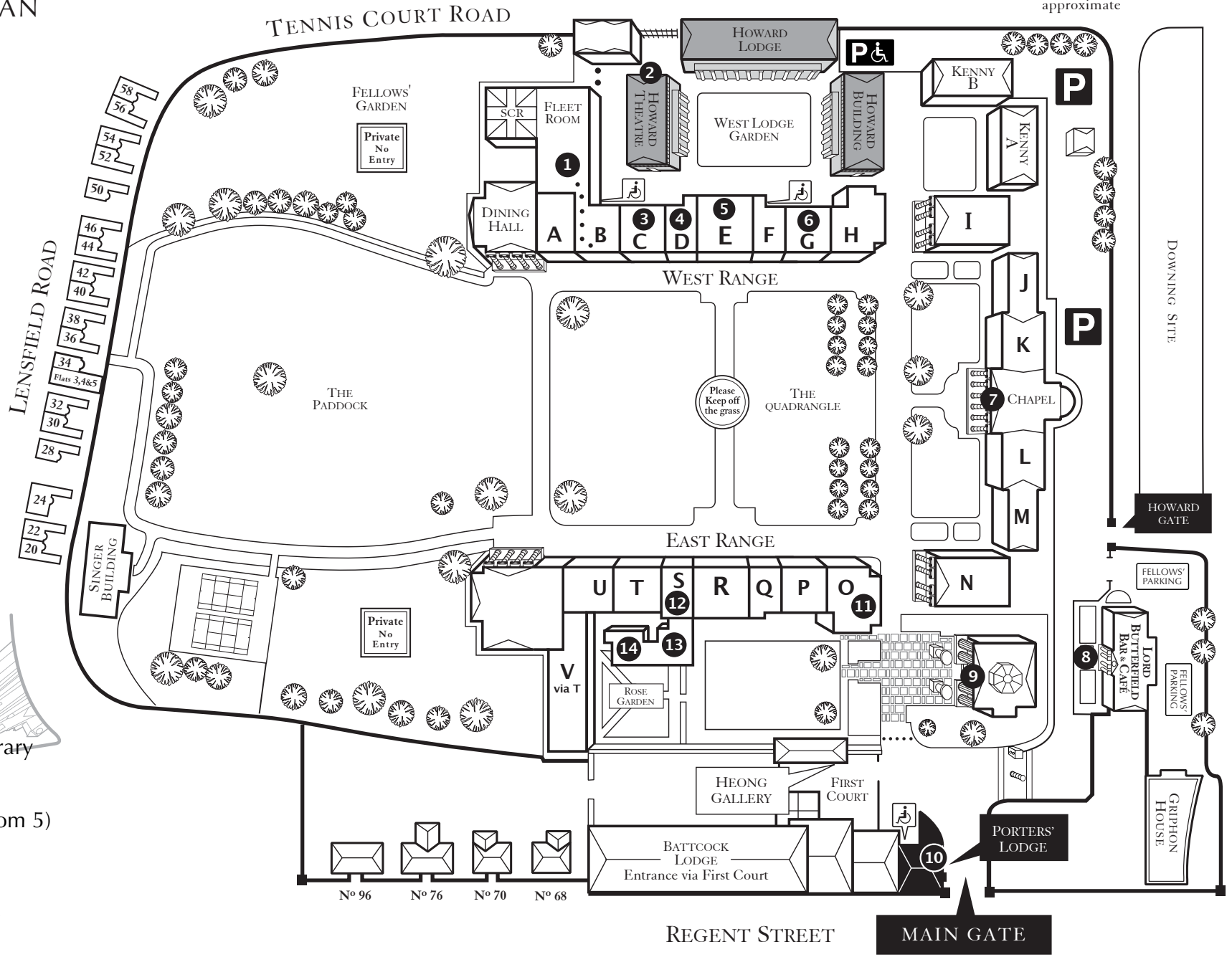

PORTERS' LODGE 01223 334800